

## HELGOLAND RECESSED

design  
Carlotta de Bevilacqua

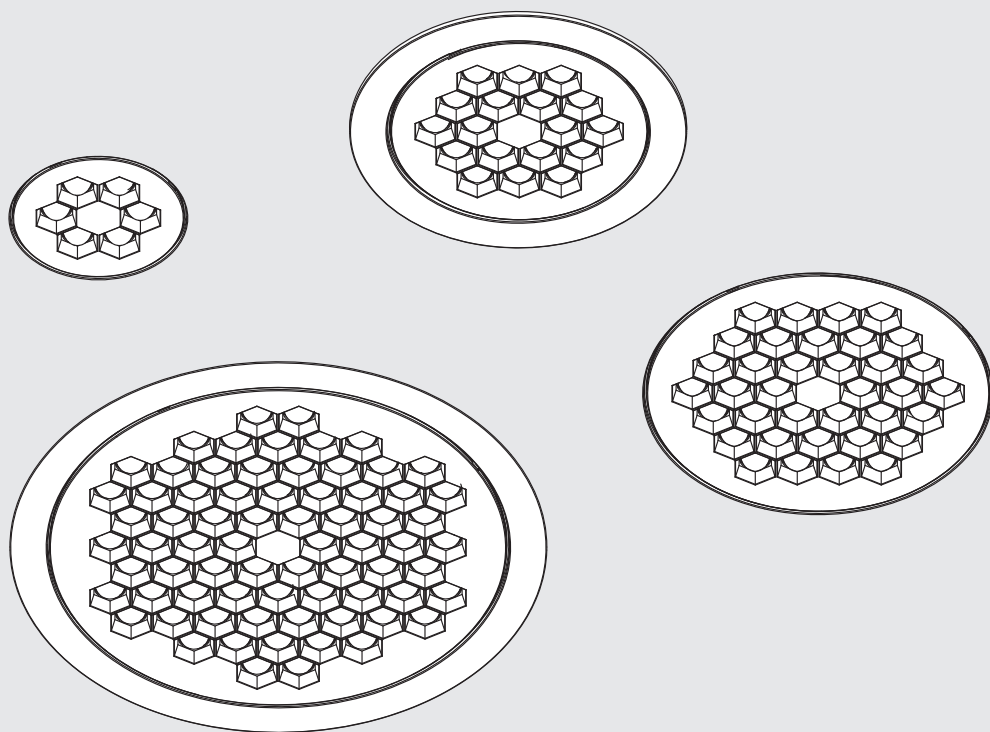



i

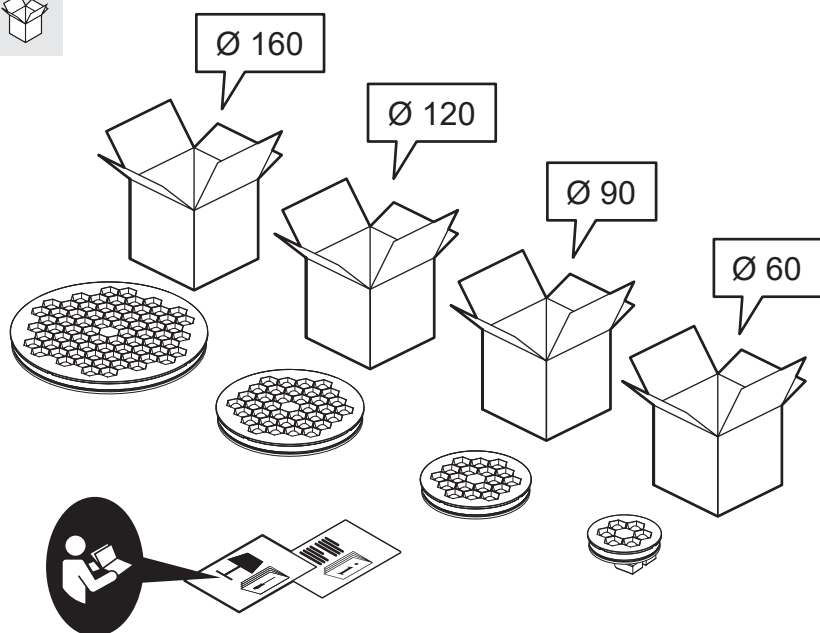
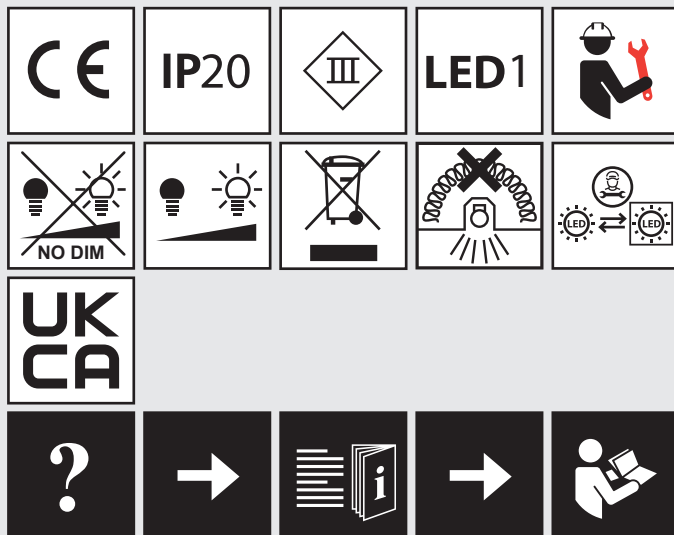



## TRIM FRAME

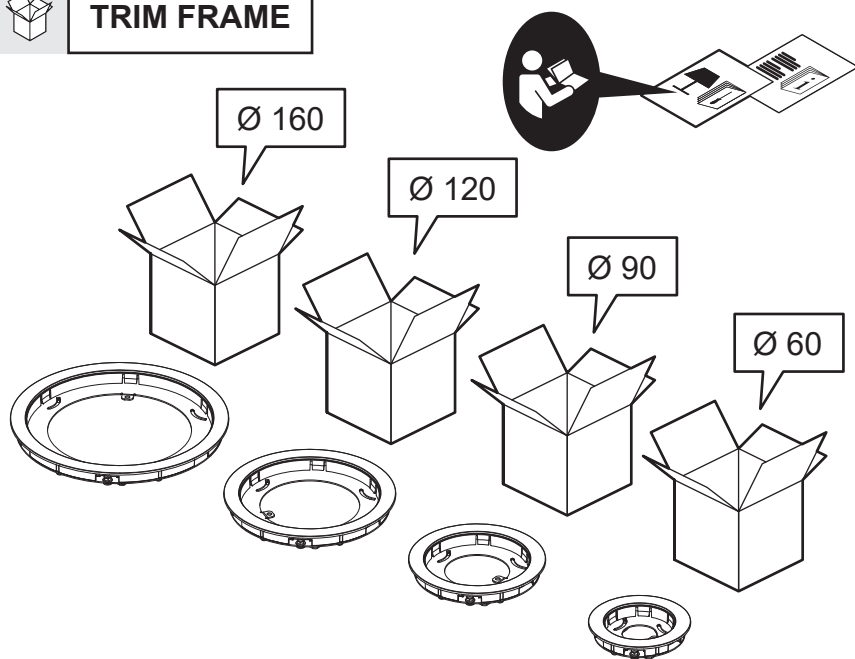

## TRIMLESS FRAME

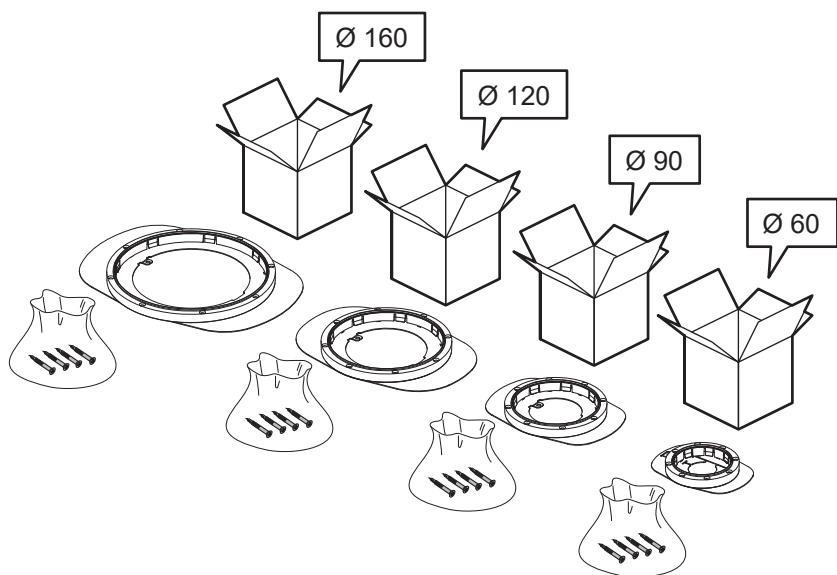



US / CANADA ONLY

AX90000

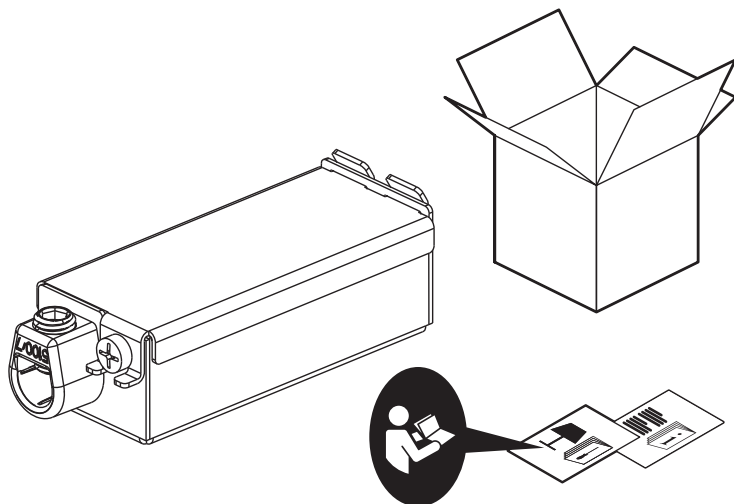

**12.5 mm !**

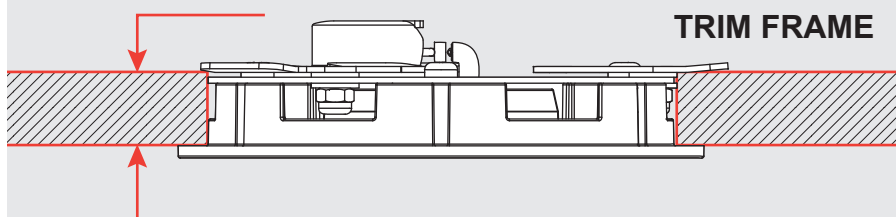

**12.5 mm !**

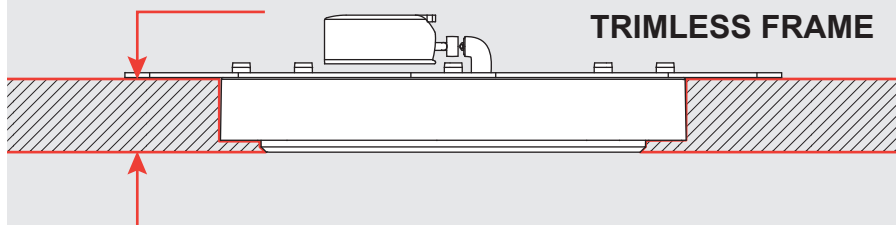



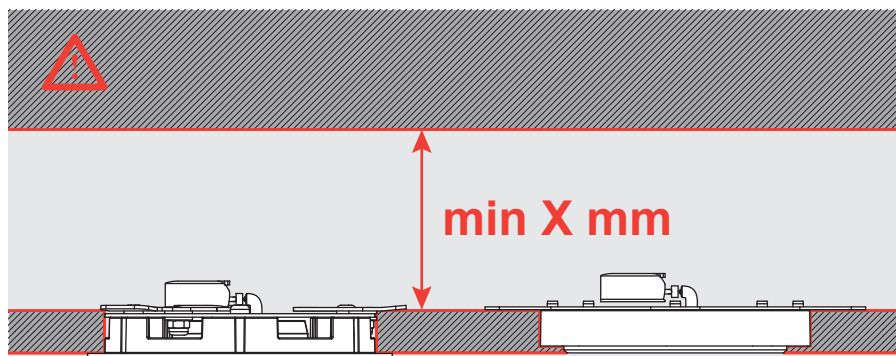

|                 |                  |
|-----------------|------------------|
| HELGOLAND Ø 60  | <b>X = 60 mm</b> |
| HELGOLAND Ø 90  | <b>X = 90 mm</b> |
| HELGOLAND Ø 120 | <b>X = 50 mm</b> |
| HELGOLAND Ø 160 | <b>X = 30 mm</b> |

**i**

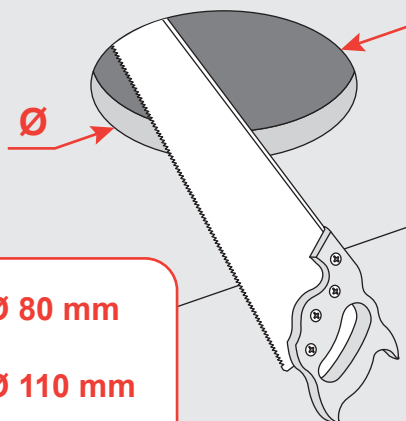

|   |                         |
|---|-------------------------|
|  | Ø 60 → <b>Ø 80 mm</b>   |
|  | Ø 90 → <b>Ø 110 mm</b>  |
|  | Ø 120 → <b>Ø 140 mm</b> |
|  | Ø 160 → <b>Ø 180 mm</b> |

**EU / WORLDWIDE**

# TRIM FRAME

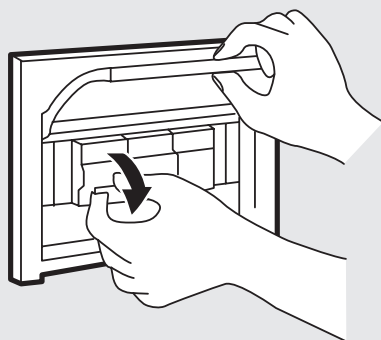

i

Ø 60

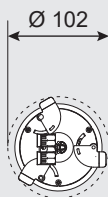

Ø 90

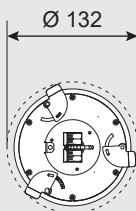

Ø 120

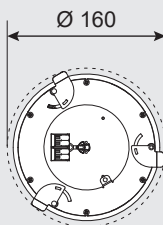

Ø 160

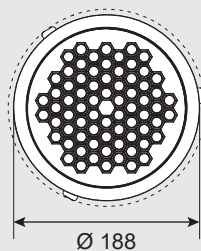
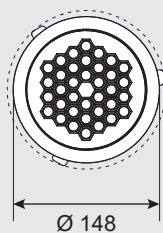
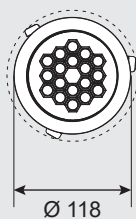
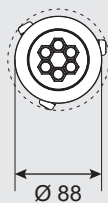
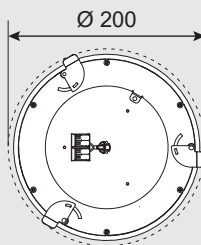

1a

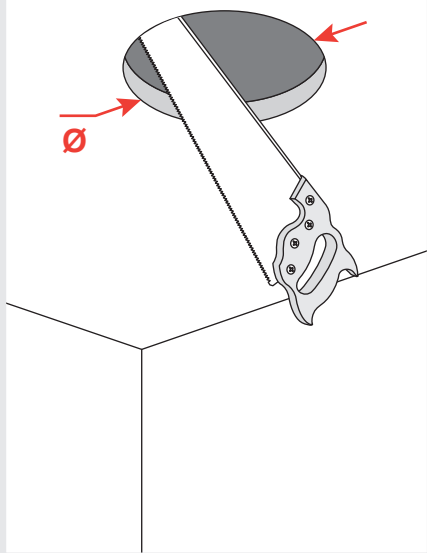

2a

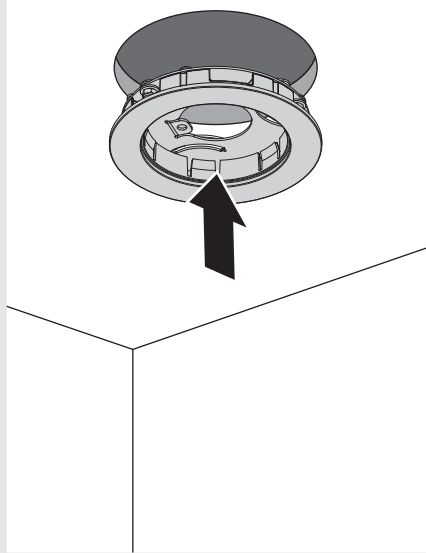

3a

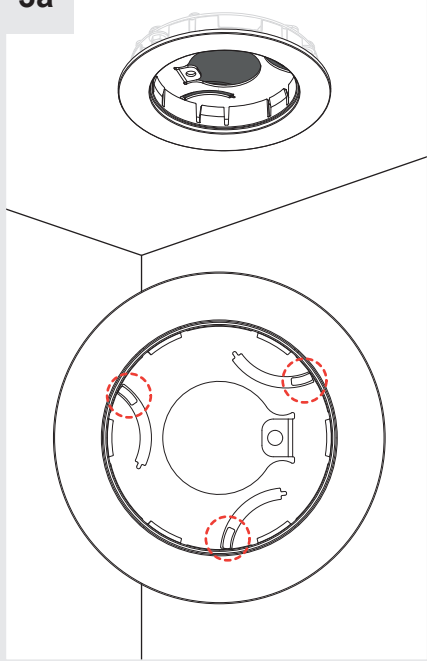

4a

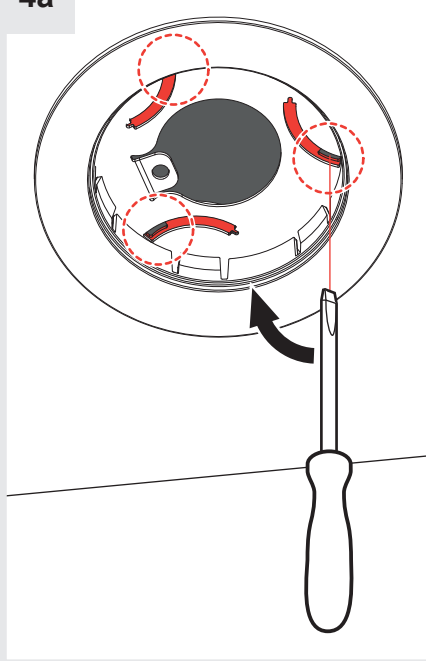

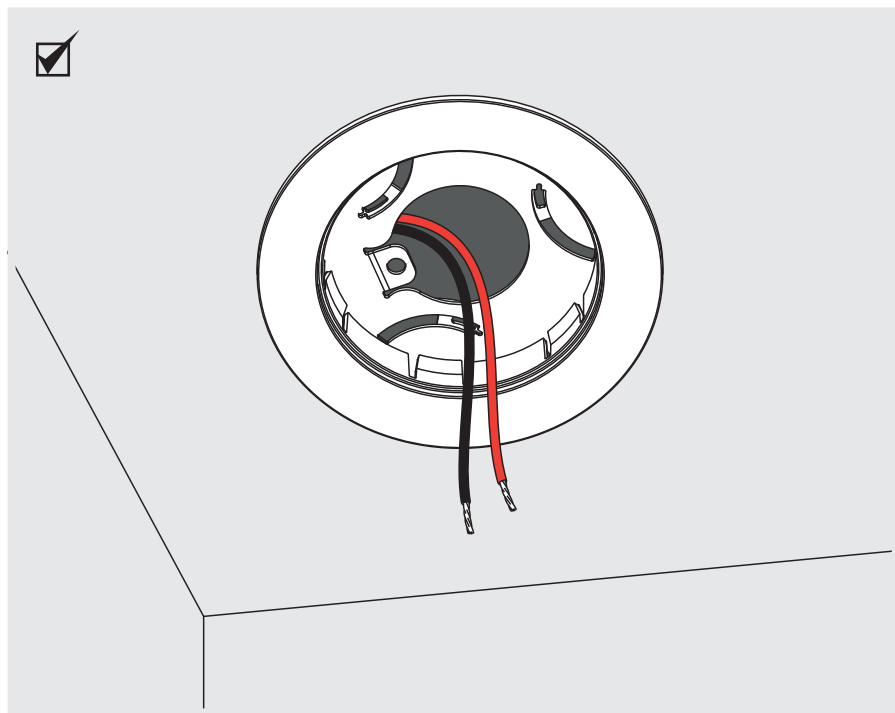
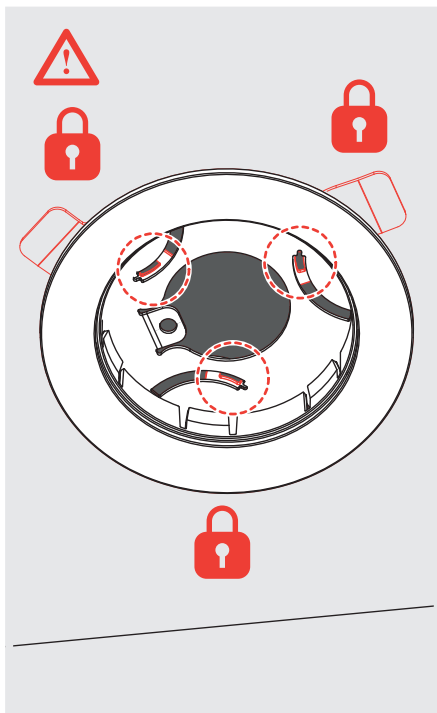
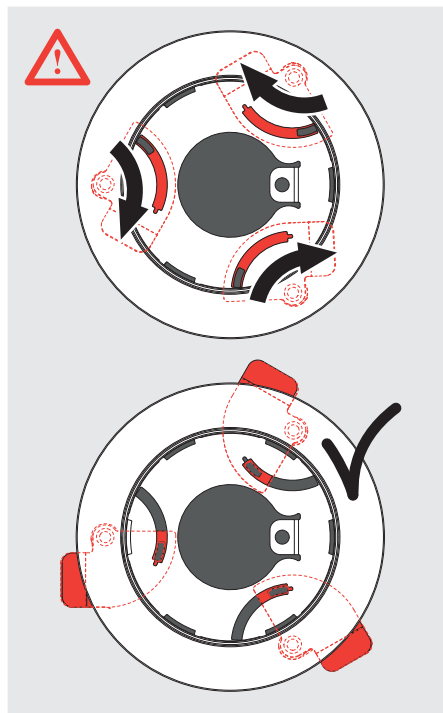

# TRIMLESS FRAME

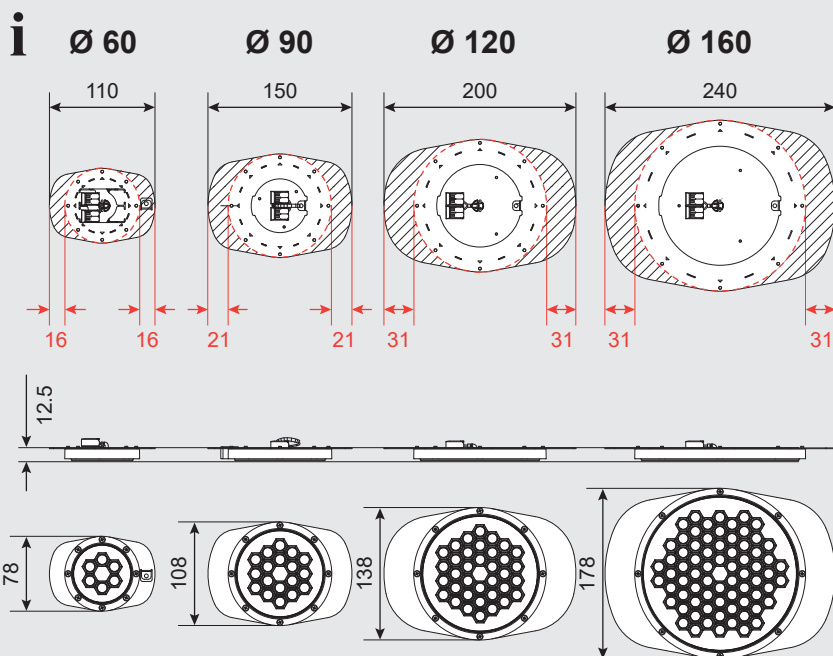
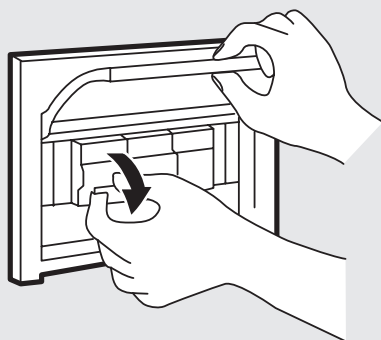

1b

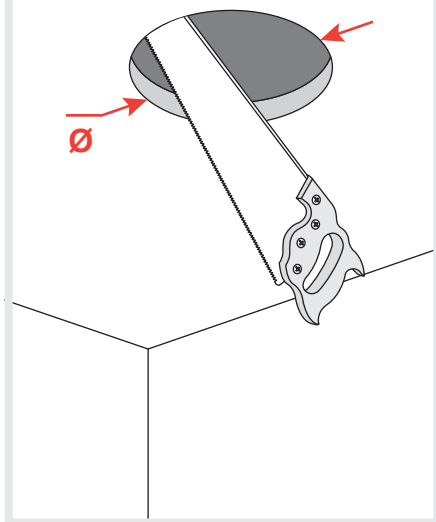

2b

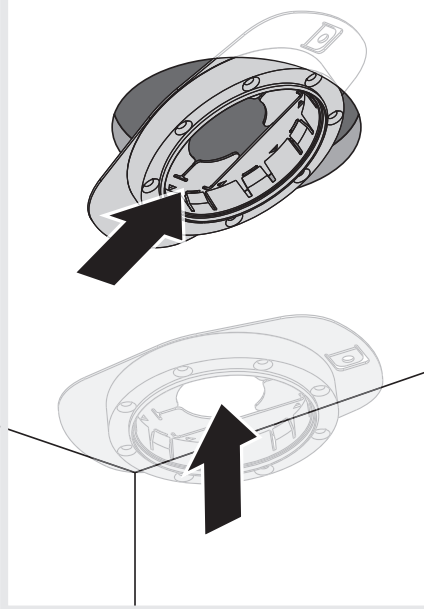

i

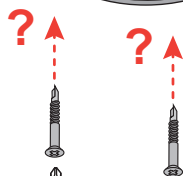

Ø 60

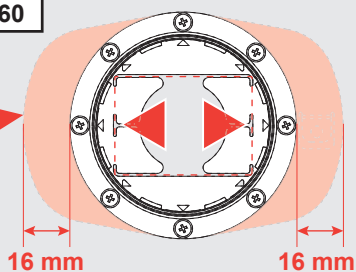

Ø 90-120-160

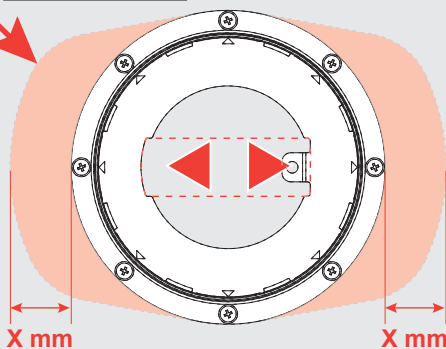

| Ø      | 90 | 120 | 160 |
|--------|----|-----|-----|
| X [mm] | 21 | 31  | 31  |

3b

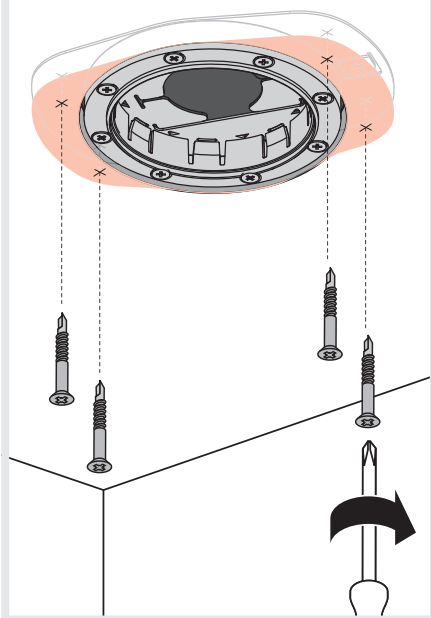

4b

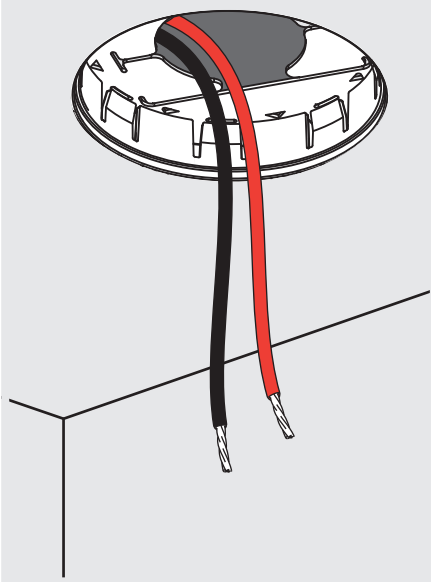
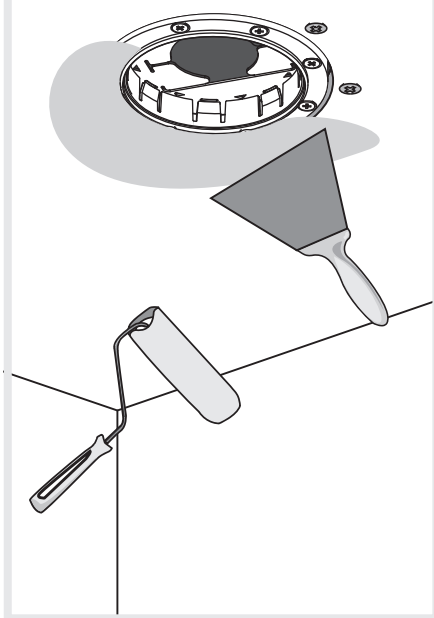



# TRIM FRAME & TRIMLESS FRAME

5

## OPTION 1

$L_{\max} - \varnothing_{\min}$



|   |          |    |
|---|----------|----|
| $L_{\max}$ [m]                          | 20       | 15 |
| $\varnothing_{\min}$ [mm <sup>2</sup> ] | min 0,50 |    |



- ⊕ Rosso/Red/Rouge/Rojo/Rot
- ⊖ Nero/Black/Noir/Negro/Schwarz

3°



11 mm

2°

1°

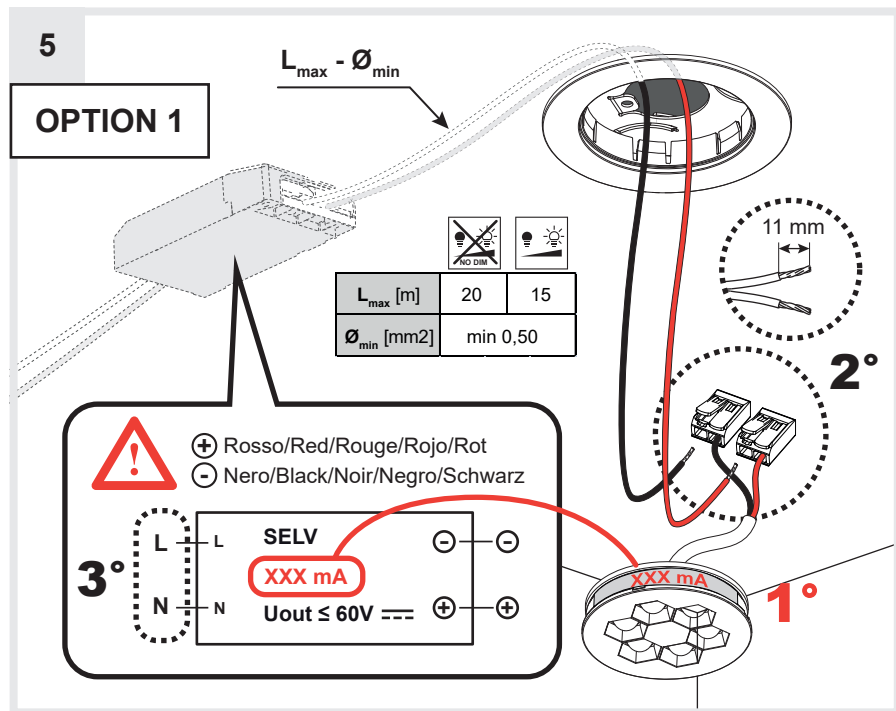

# OPTION 2

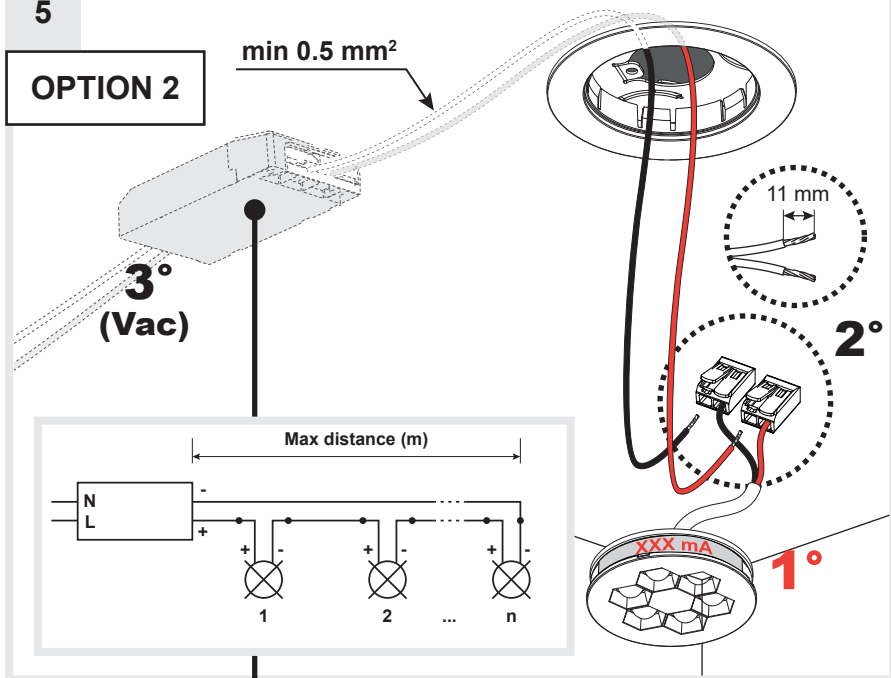

| Helgoland sizes<br>[Ø mm] | Remote driver type        | Code      | Driver dimensions |           |           | Circuit breaker                           | Max distance<br>[m] | Current setting<br>[mA] | V module | Devices nr.    |
|---------------------------|---------------------------|-----------|-------------------|-----------|-----------|---|---------------------|-------------------------|----------|----------------|
|                           |                           |           | L<br>[mm]         | W<br>[mm] | H<br>[mm] |   |                     |                         |          |                |
| 60                        | ND                        | DV1037    | 146.5             | 42.5      | 22        | A 16-30<br>B 16-50<br>C 16-70             | 20                  | 300                     | 8.5V     | 2 min<br>4 max |
|                           | DALI2 /<br>0-10 /<br>PUSH | DV1126    | 111               | 52        | 22        | A 16-30<br>B 16-50<br>C 16-70<br>D 16-100 | 15                  |                         |          | 1 min<br>5 max |
|                           | DALI2 /<br>PUSH           | DV1127    | 146.5             | 43.5      | 22        |   | 15                  |                         |          | 2 min<br>4 max |
|                           | APP &<br>PUSH             | DV1128APP | 146.5             | 44        | 30        |   | 15                  |                         |          | 2 min<br>5 max |
| 90                        | ND                        | DV1037    | 146.5             | 42.5      | 22        | A 16-30<br>B 16-50<br>C 16-70             | 20                  | 350                     | 17V      | 1 min<br>2 max |
|                           | DALI2 /<br>0-10 /<br>PUSH | DV1126    | 111               | 52        | 22        | A 16-30<br>B 16-50<br>C 16-70<br>D 16-100 | 15                  |                         |          | 1 min<br>2 max |
|                           | APP &<br>PUSH             | DV1129APP | 146.5             | 44        | 30        |   | 15                  |                         |          | 1 min<br>2 max |

| Helgoland<br>sizes<br>[Ø mm] | Remote<br>driver<br>type  | Code      | Driver dimensions |           |           | Circuit<br>breaker                        | Max<br>distance<br>[m] | Current<br>setting<br>[mA] | V<br>module | Devices<br>nr. |
|------------------------------|---------------------------|-----------|-------------------|-----------|-----------|---|------------------------|----------------------------|-------------|----------------|
|                              |                           |           | L<br>[mm]         | W<br>[mm] | H<br>[mm] |   |                        |                            |             |                |
| 120                          | ND                        | DV1037    | 146.5             | 42.5      | 22        | A 16-30<br>B 16-50<br>C 16-70             | 20                     | 500                        | 17V         | 1 min<br>2 max |
|                              | DALI2 /<br>0-10 /<br>PUSH | DV1126    | 111               | 52        | 22        | A 16-30<br>B 16-50<br>C 16-70<br>D 16-100 | 15                     |                            |             | 1 min<br>2 max |
|                              | APP &<br>PUSH             | DV1104APP | 124               | 79        | 22        | A 16-20<br>B 16-30<br>C 16-50             | 15                     |                            |             | 1 min<br>2 max |
| 160                          | ND                        | DV1037    | 146.5             | 42.5      | 22        | A 16-30<br>B 16-50<br>C 16-70             | 20                     | 500                        | 34V         | 1 max          |
|                              | DALI2 /<br>0-10 /<br>PUSH | DV1126    | 111               | 52        | 22        | A 16-30<br>B 16-50<br>C 16-70<br>D 16-100 | 15                     |                            |             | 1 max          |
|                              | APP &<br>PUSH             | DV1104APP | 124               | 79        | 22        | A 16-20<br>B 16-30<br>C 16-50             | 15                     |                            |             | 1 max          |

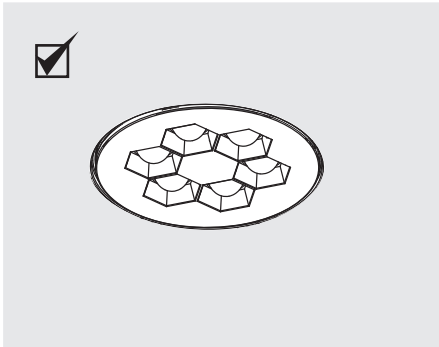
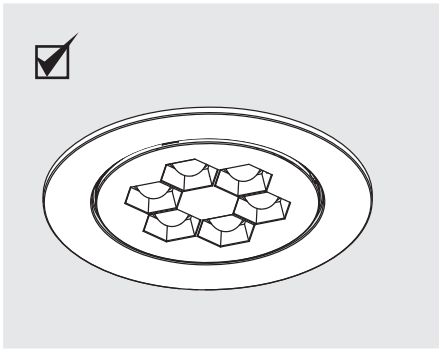
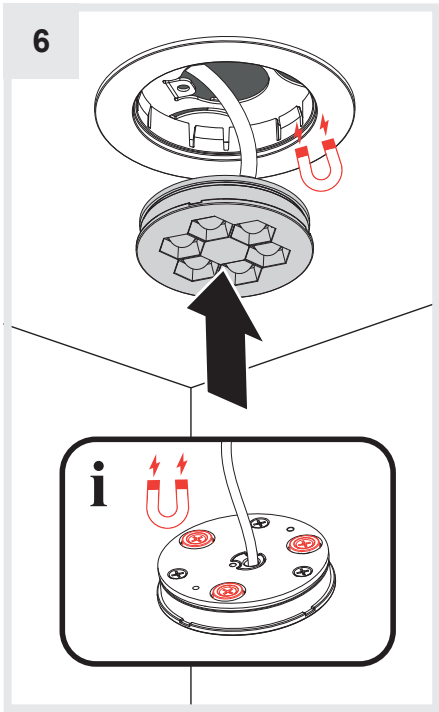

**US / CANADA ONLY**

**Ø 60**

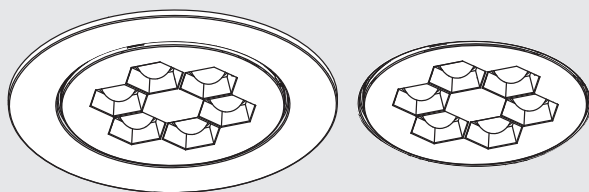

## TRIM FRAME

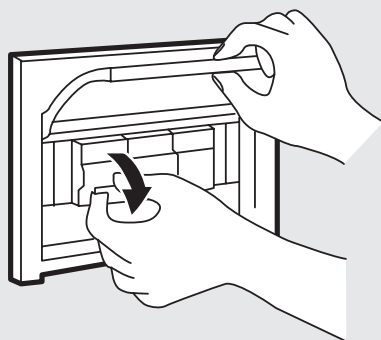

i

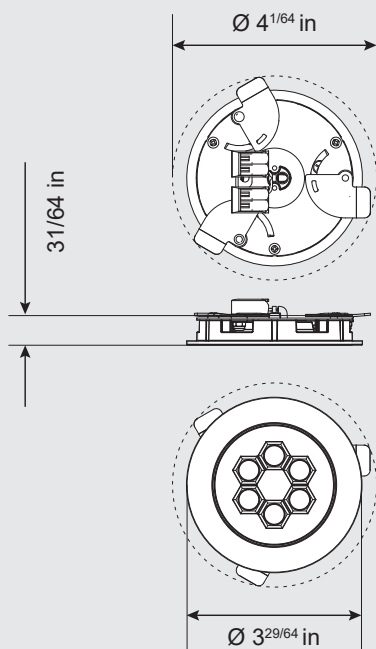

1a

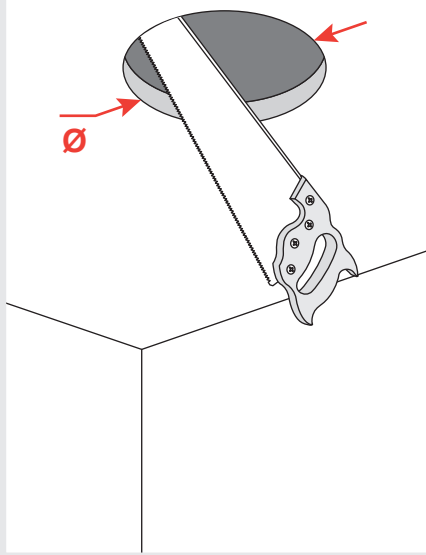

2a

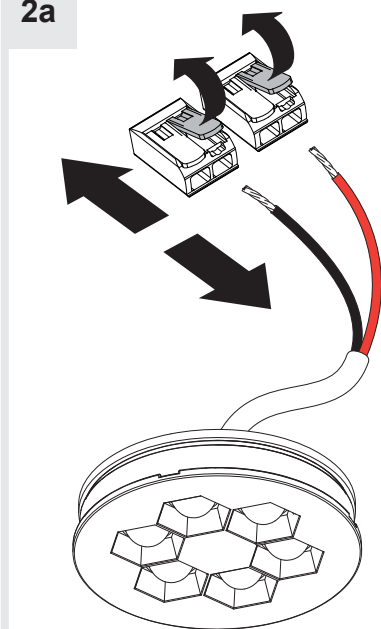

3a

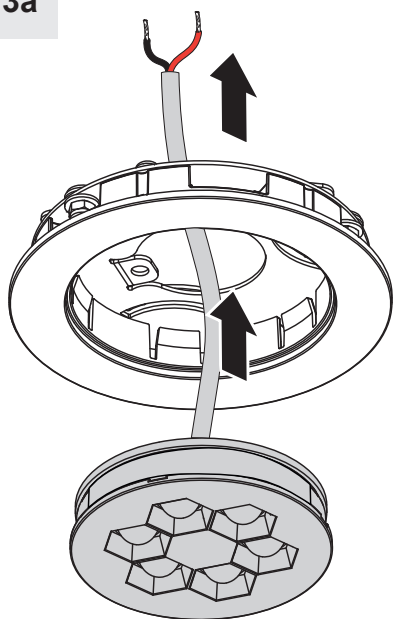

4a

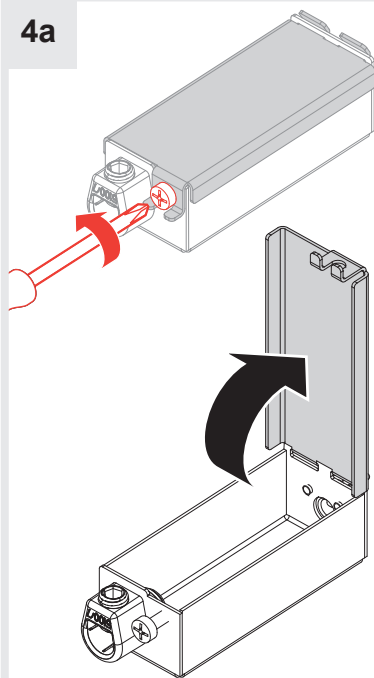

5a

Use only CMG cable  
Utilisez uniquement CMG câble  
Utilícese únicamente el cable CMG



Use only with class 2 power unit  
Utiliser exclusivement avec class 2 alimentation  
Utilícese únicamente con unidad de alimentación de clase 2

red/rouge/rojo + CLASS 2  
black/noir/negro -



⊕ Rosso/Red/Rouge/Rojo/Rot  
⊖ Nero/Black/Noir/Negro/Schwarz

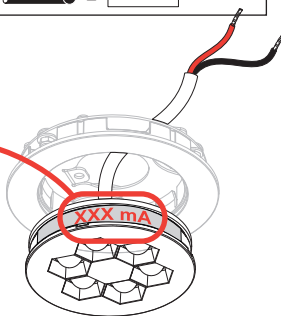
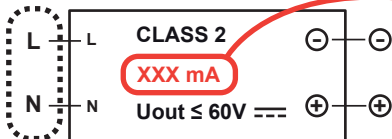

6a

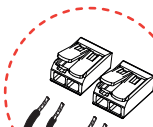

11 mm

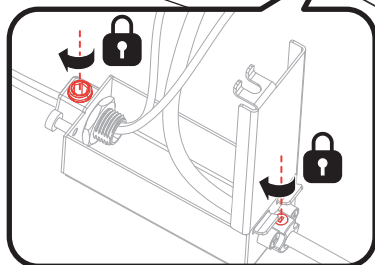
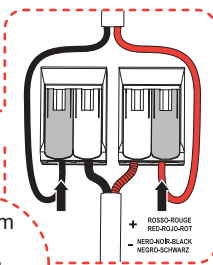

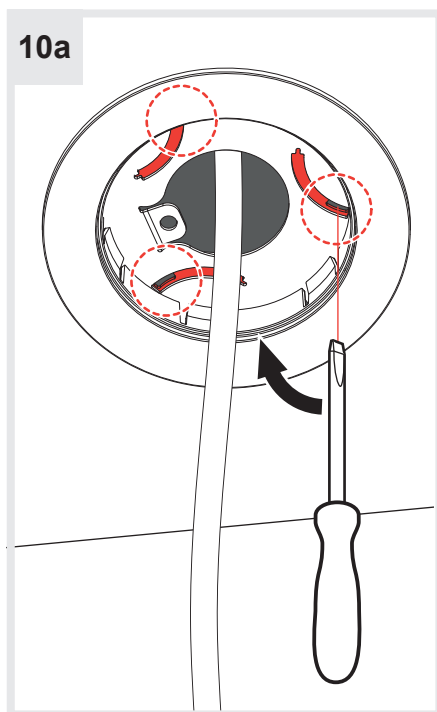
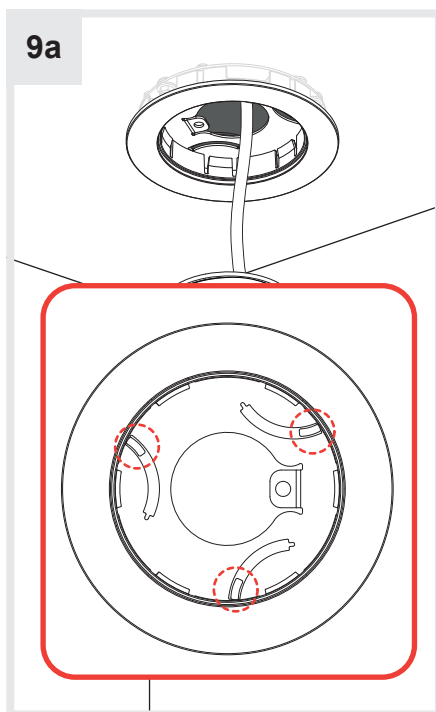
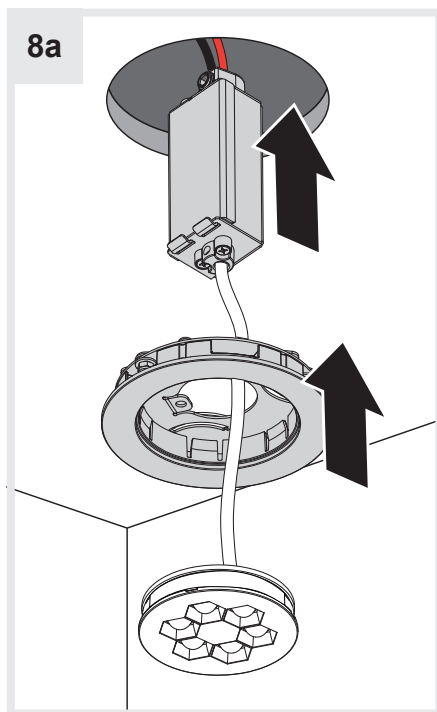
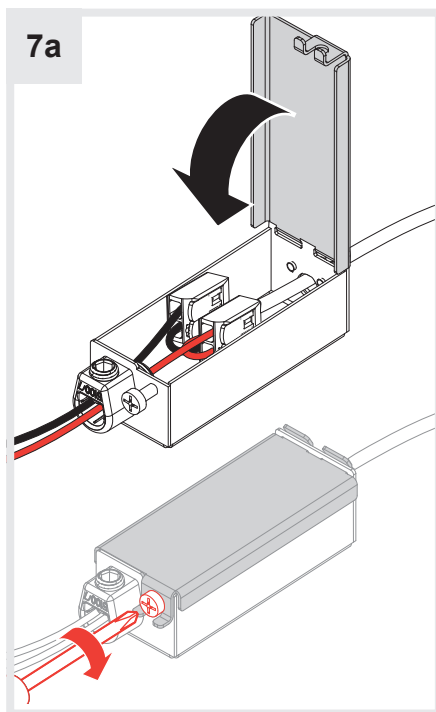



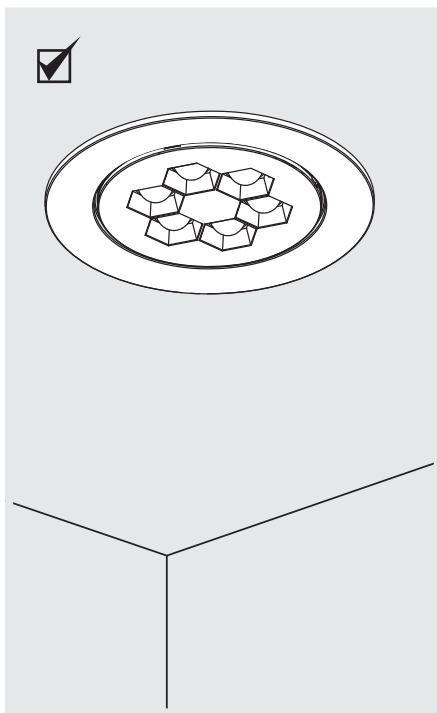
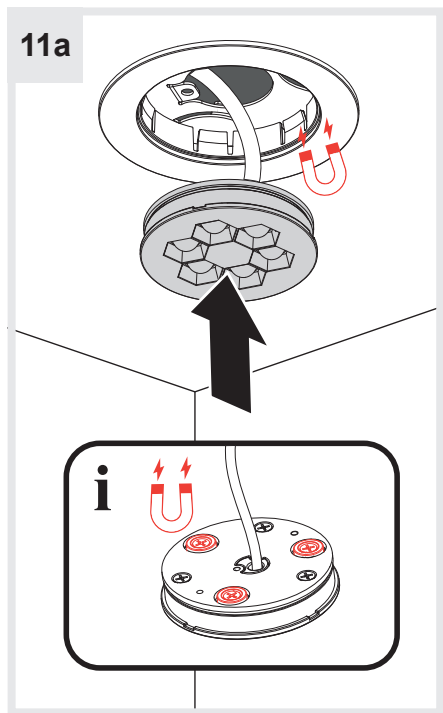
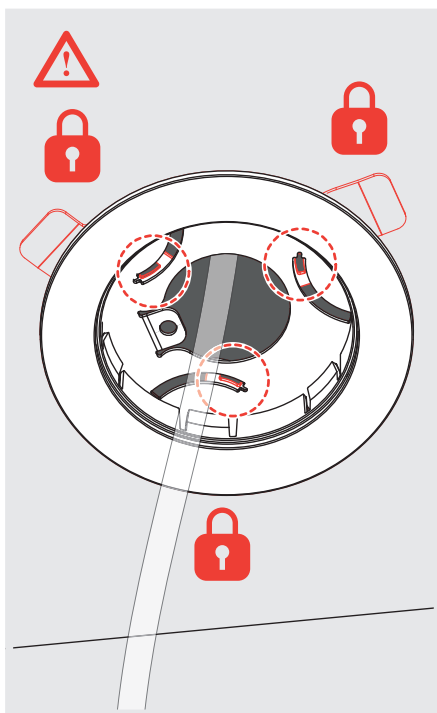
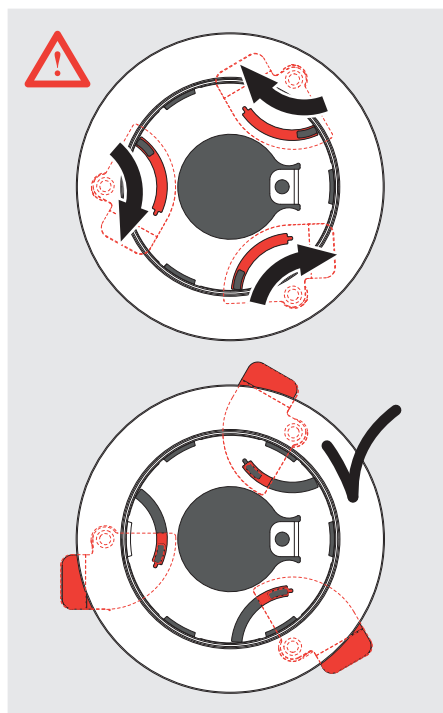

## TRIMLESS FRAME

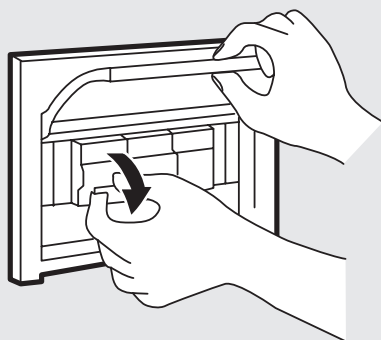

**i**

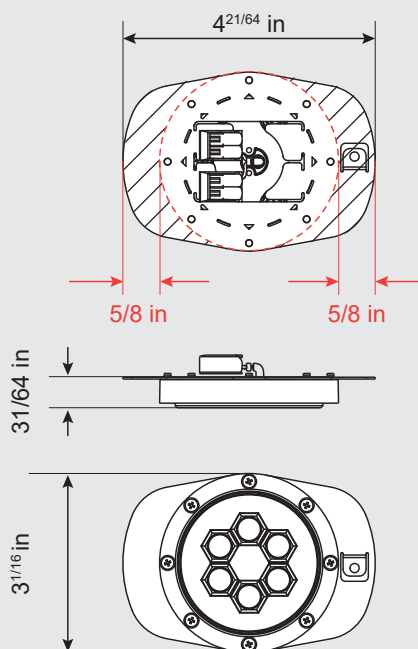

1b

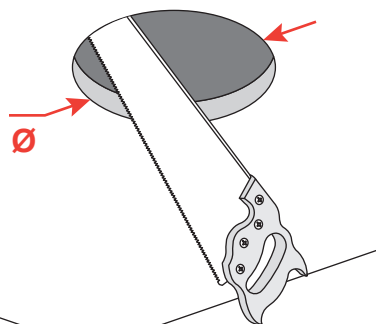

2b

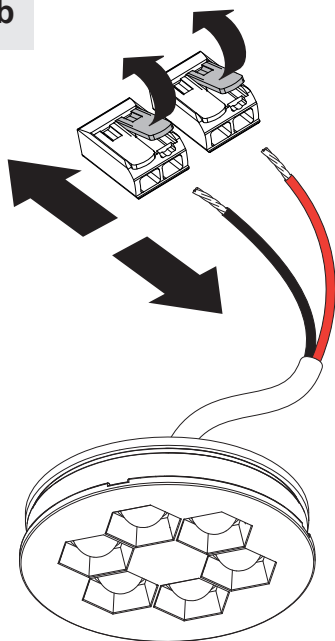

3b

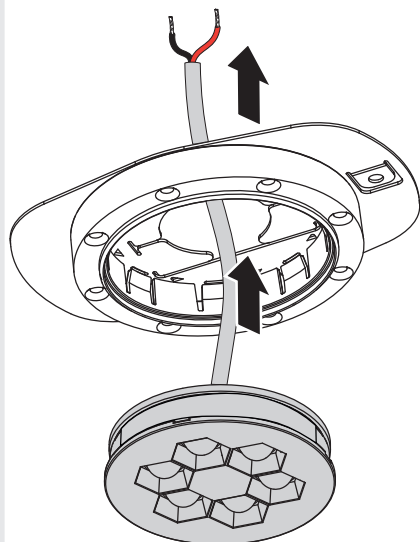

4b

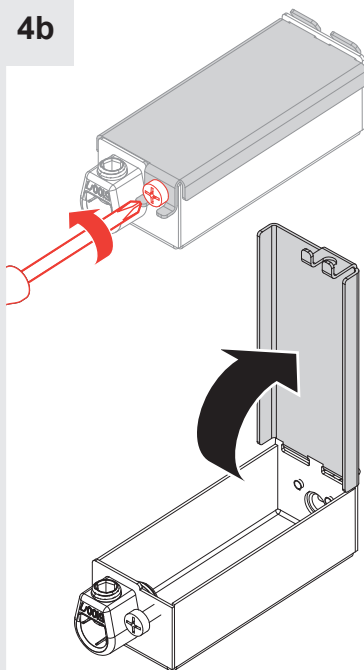

5b

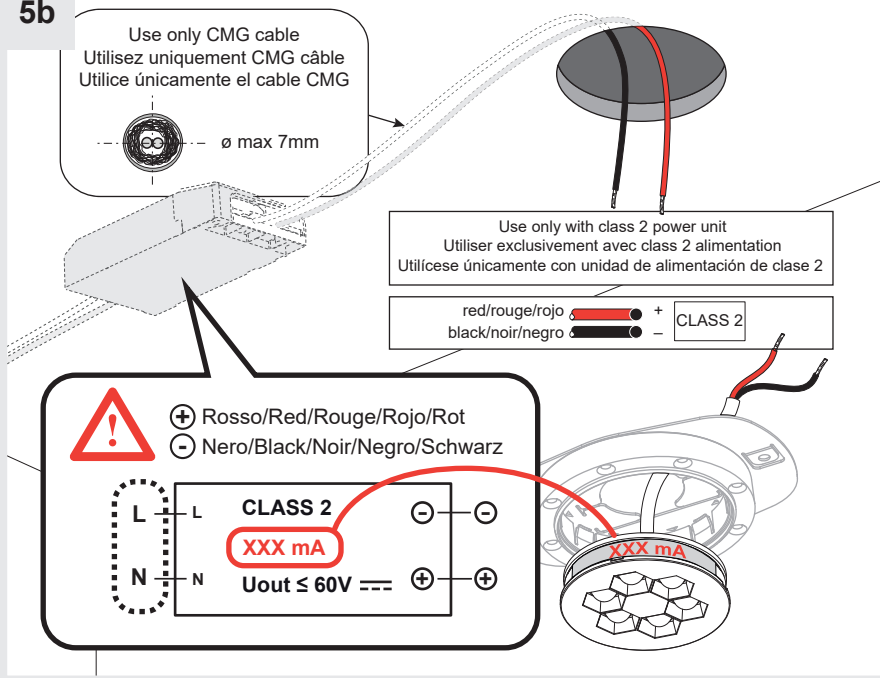

6b

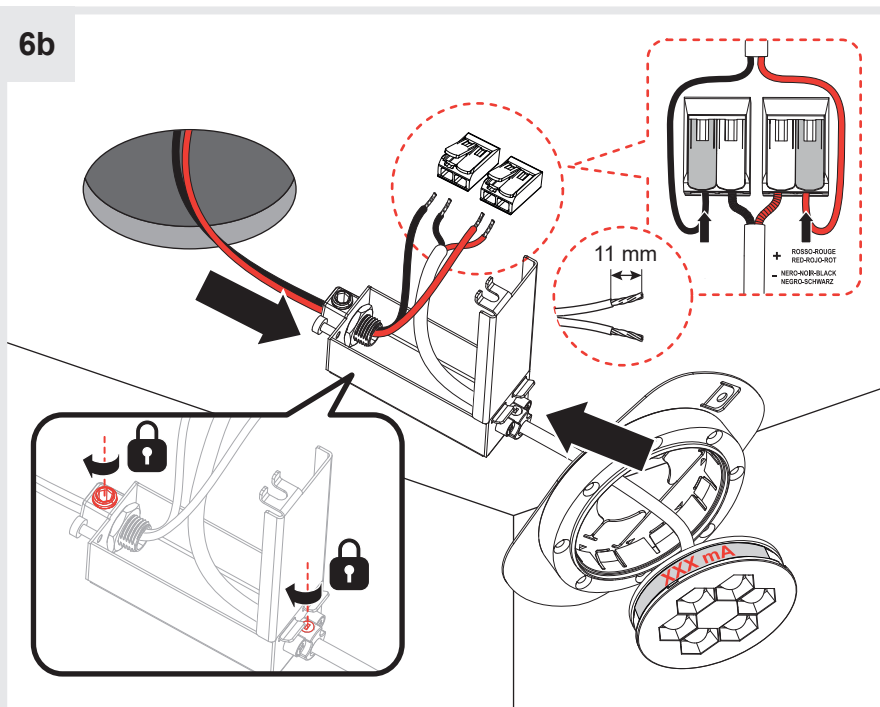

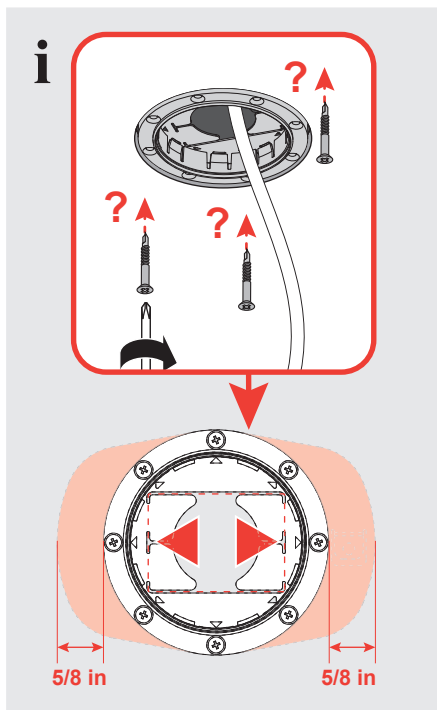
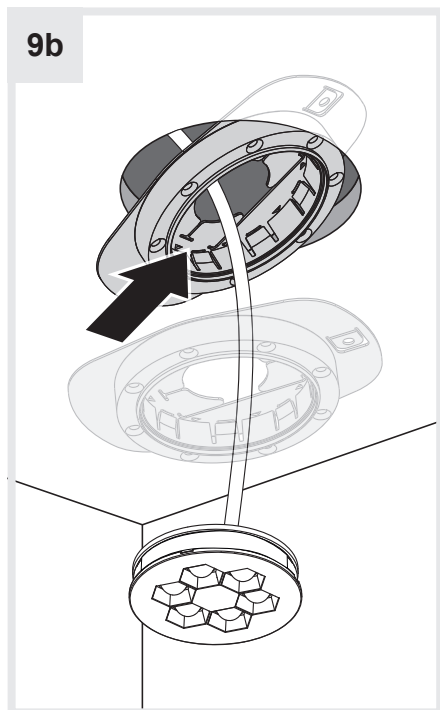
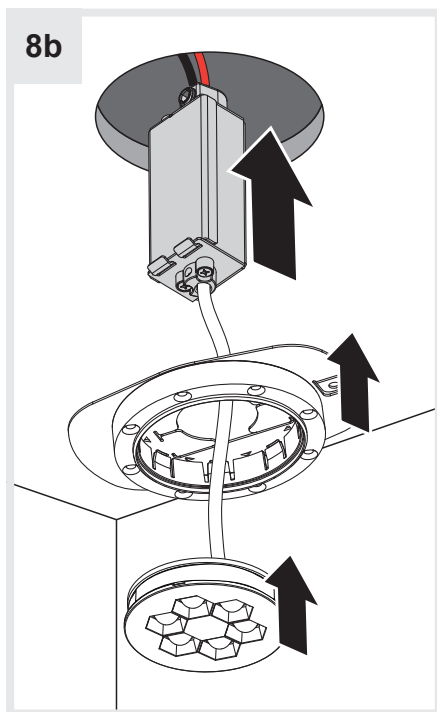
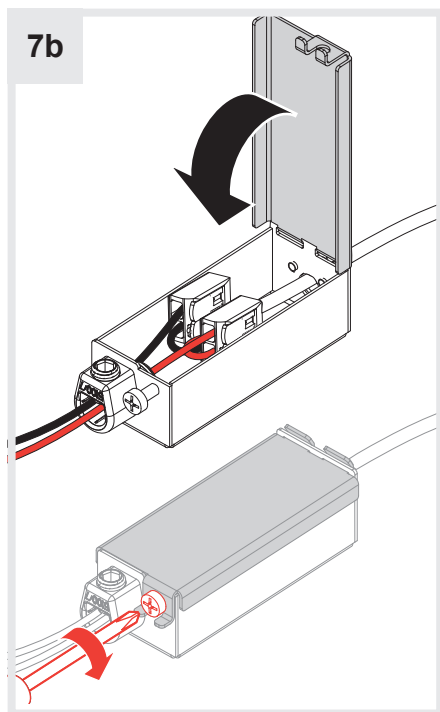

10b

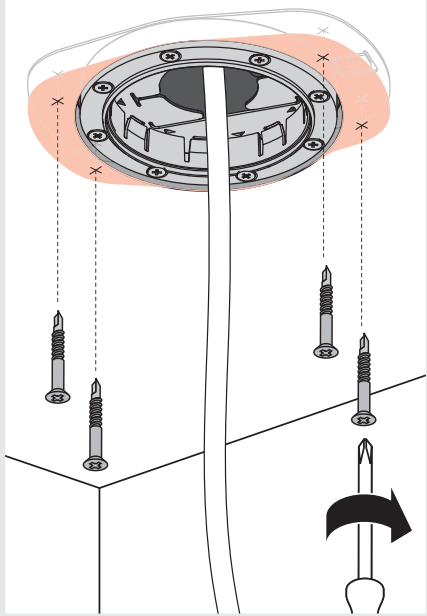

11b

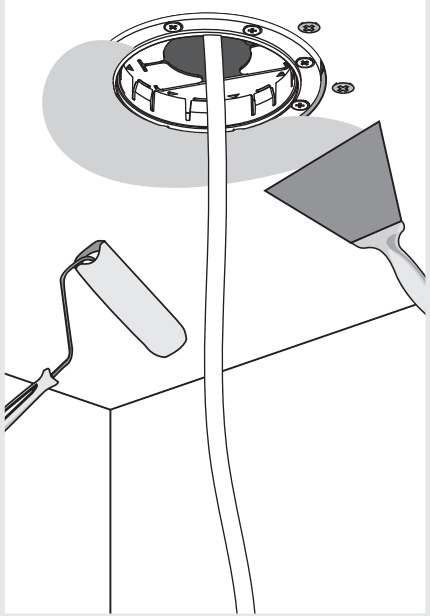

12b

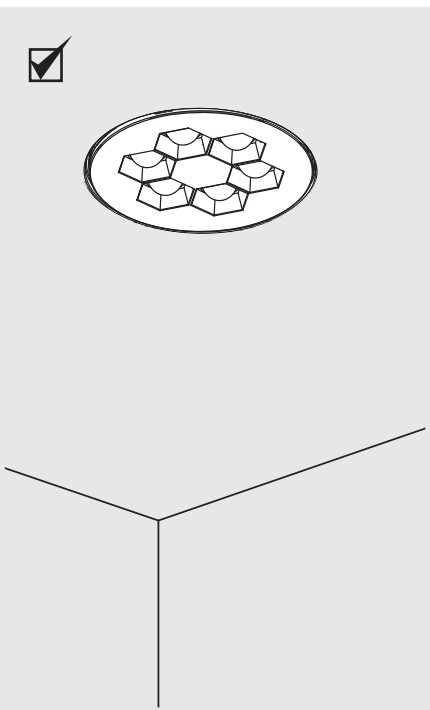
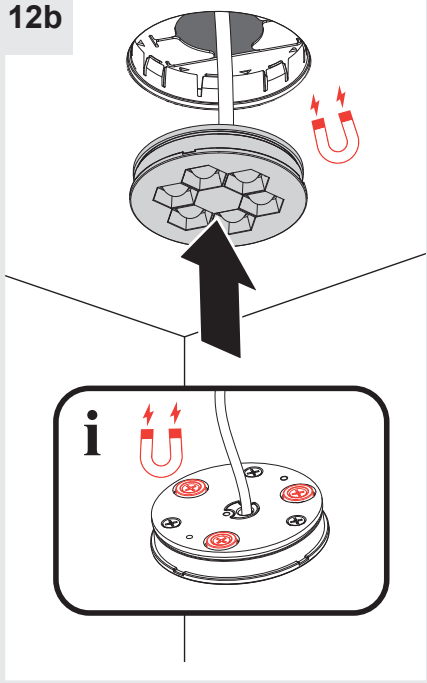

# US / CANADA ONLY

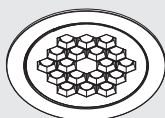

Ø 90

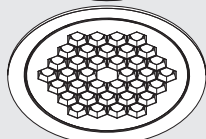

Ø 120

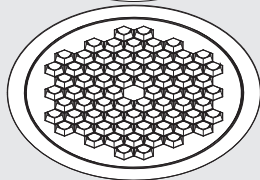
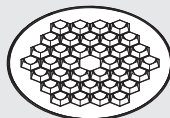

Ø 160

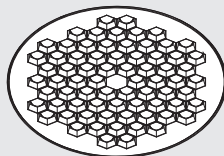

# TRIM FRAME

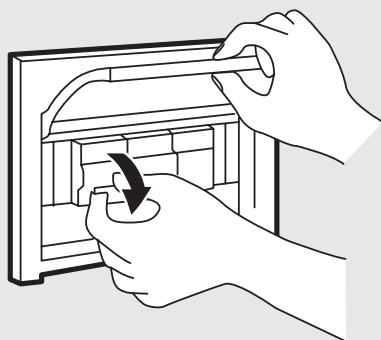

**i**

**Ø 90**

**Ø 120**

**Ø 160**

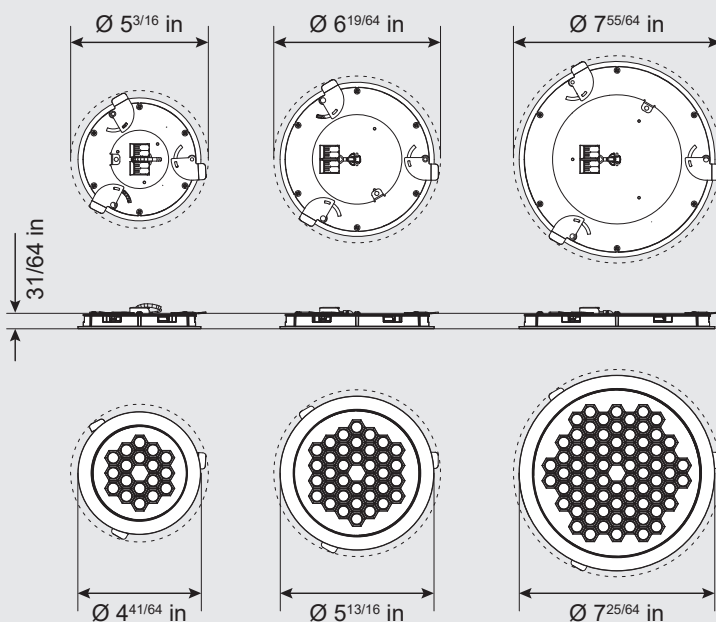



1a

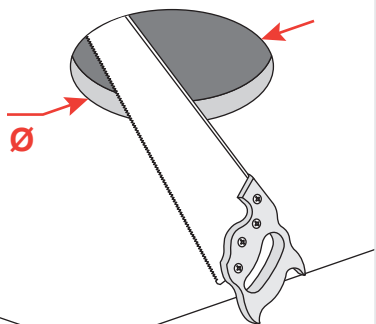

2a

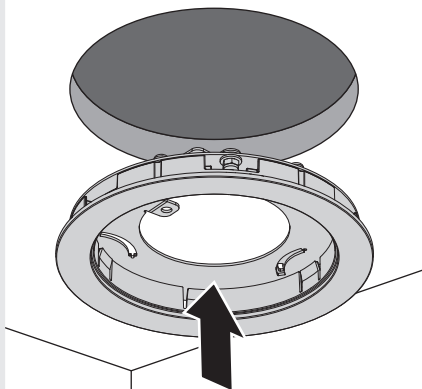

3a

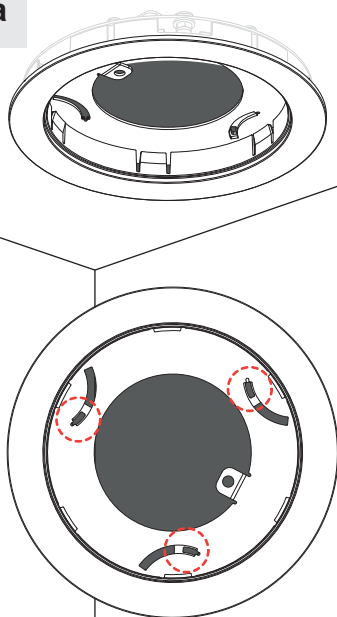

4a

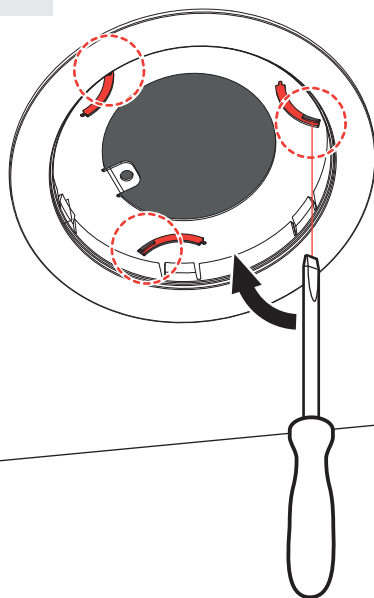

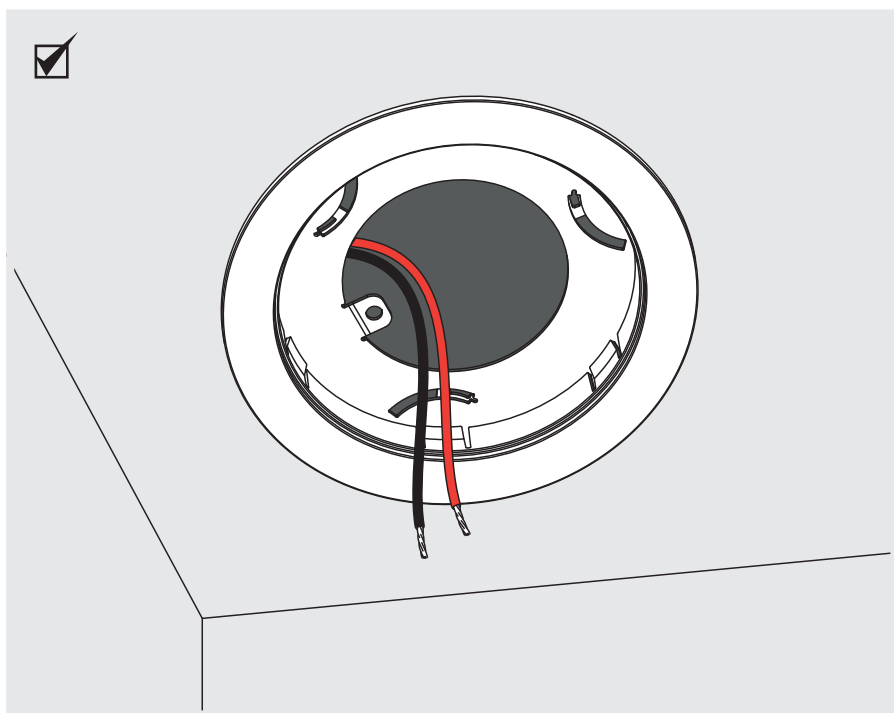
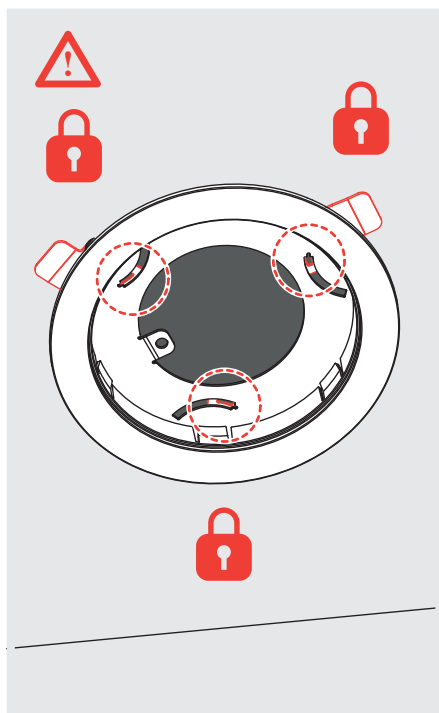
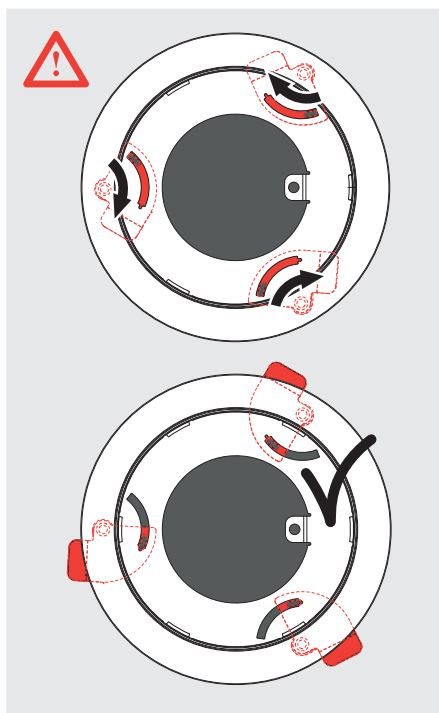

# TRIMLESS FRAME

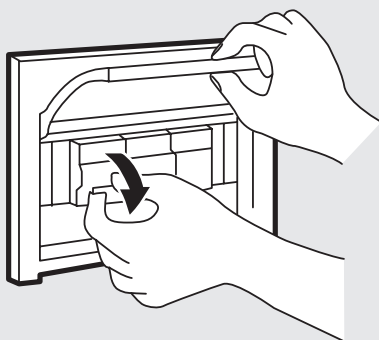

**i**

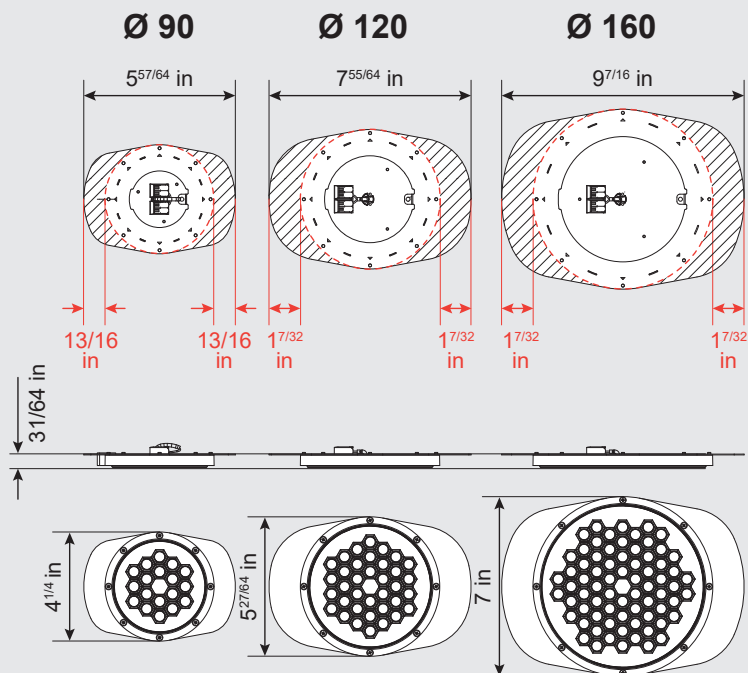

1b

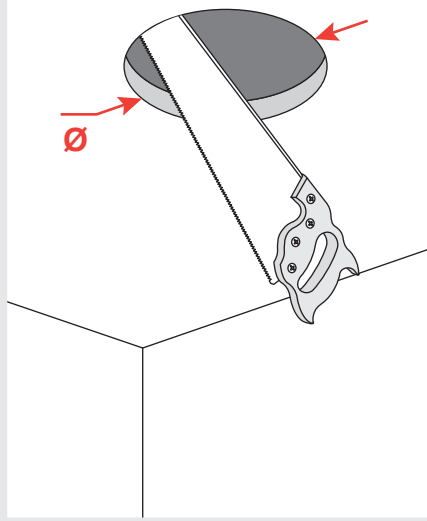

2b

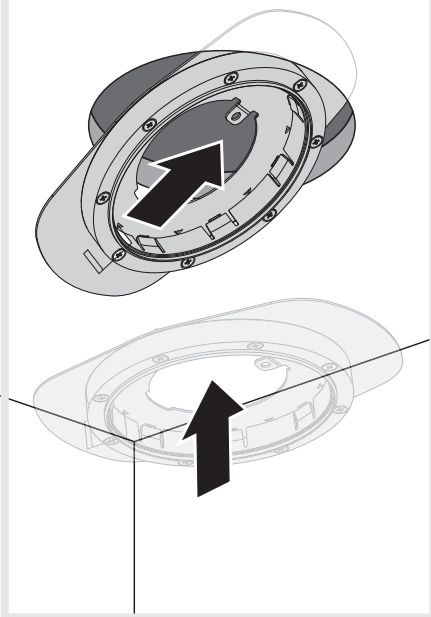

i

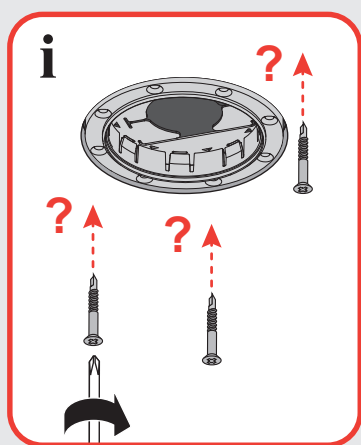

Ø 90-120-160

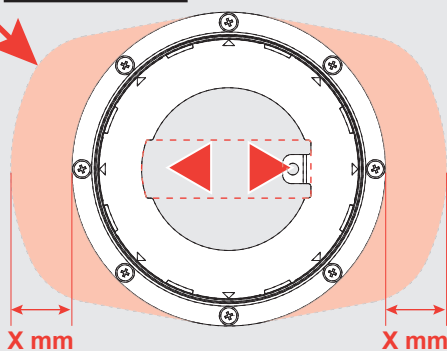

| Ø      | 90 | 120 | 160 |
|--------|----|-----|-----|
| X [mm] | 21 | 31  | 31  |

3b

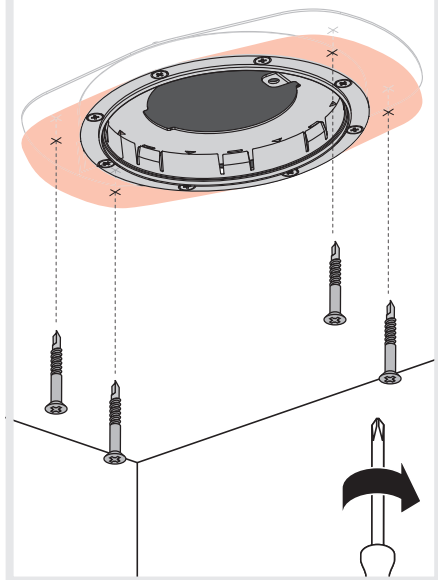

4b

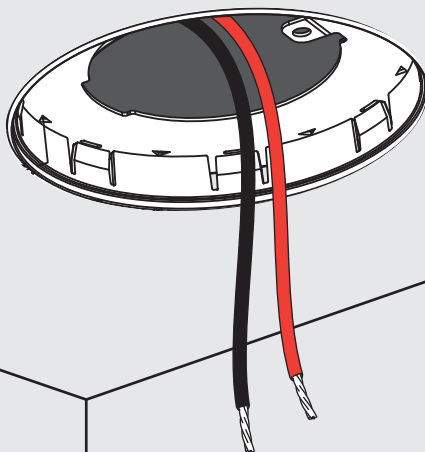
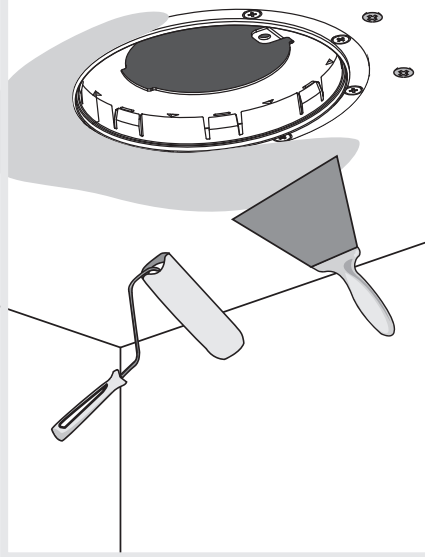

# TRIM FRAME & TRIMLESS FRAME

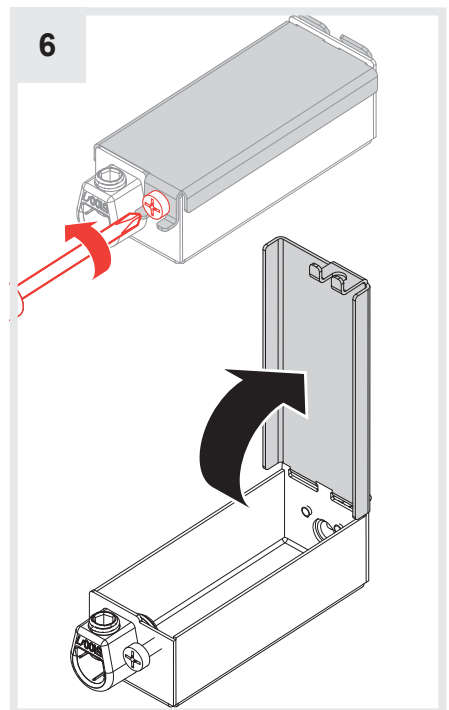
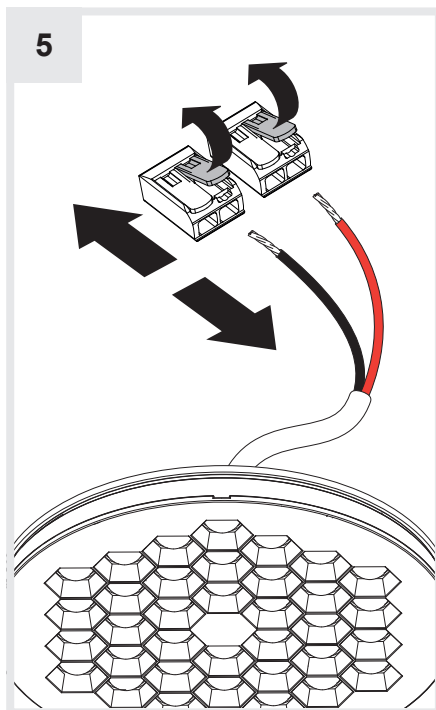

7

Use only CMG cable  
Utilisez uniquement CMG câble  
Utilice únicamente el cable CMG

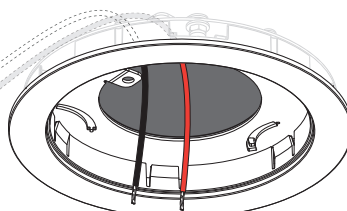
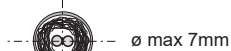

Use only with class 2 power unit  
Utiliser exclusivement avec class 2 alimentation  
Utilícese únicamente con unidad de alimentación de clase 2

red/rouge/rojo + CLASS 2  
black/noir/negro - CLASS 2



⊕ Rosso/Red/Rouge/Rojo/Rot  
⊖ Nero/Black/Noir/Negro/Schwarz



CLASS 2

XXX mA

Uout ≤ 60V ===

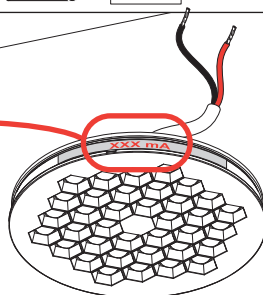

8

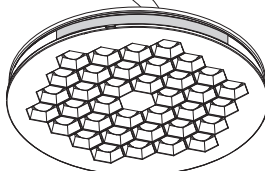
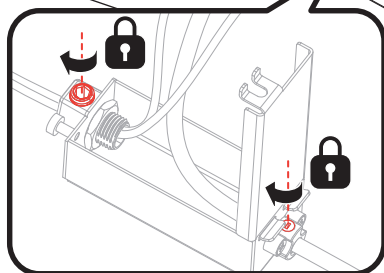
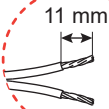
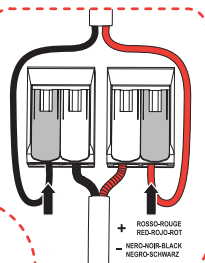
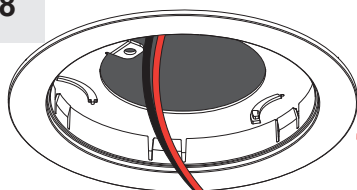

9

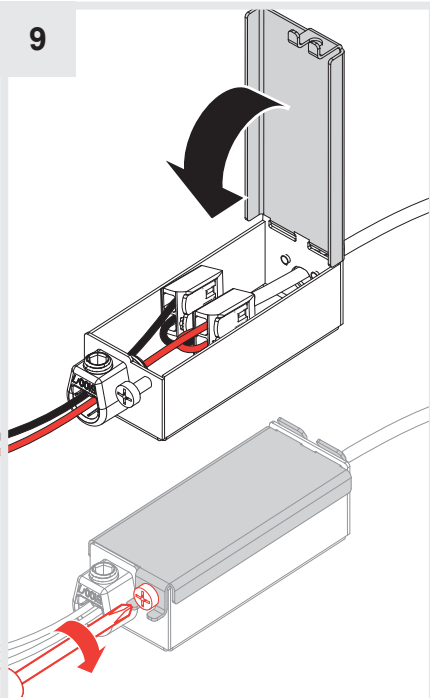

10

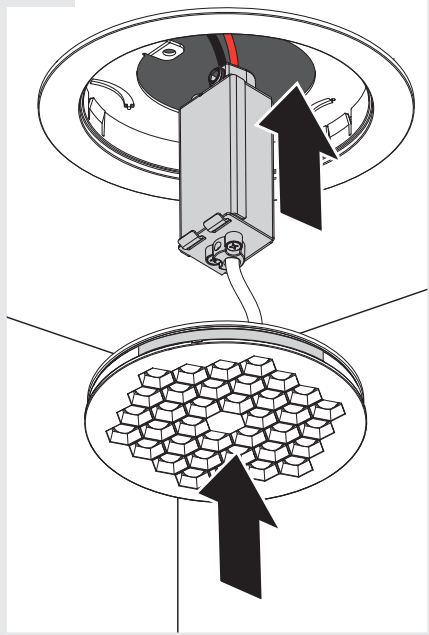

11

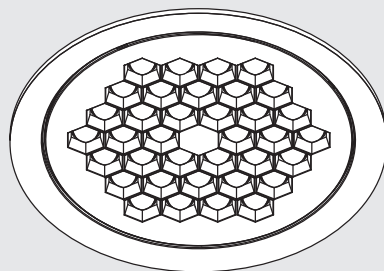
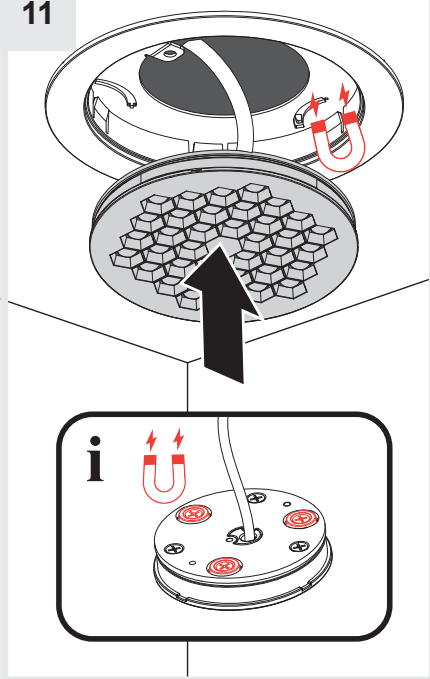



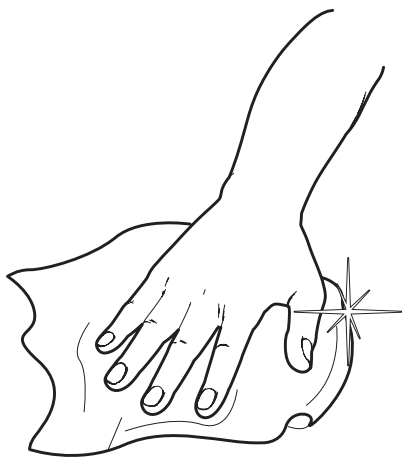
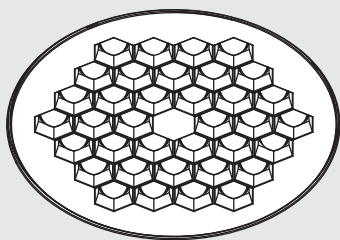



1

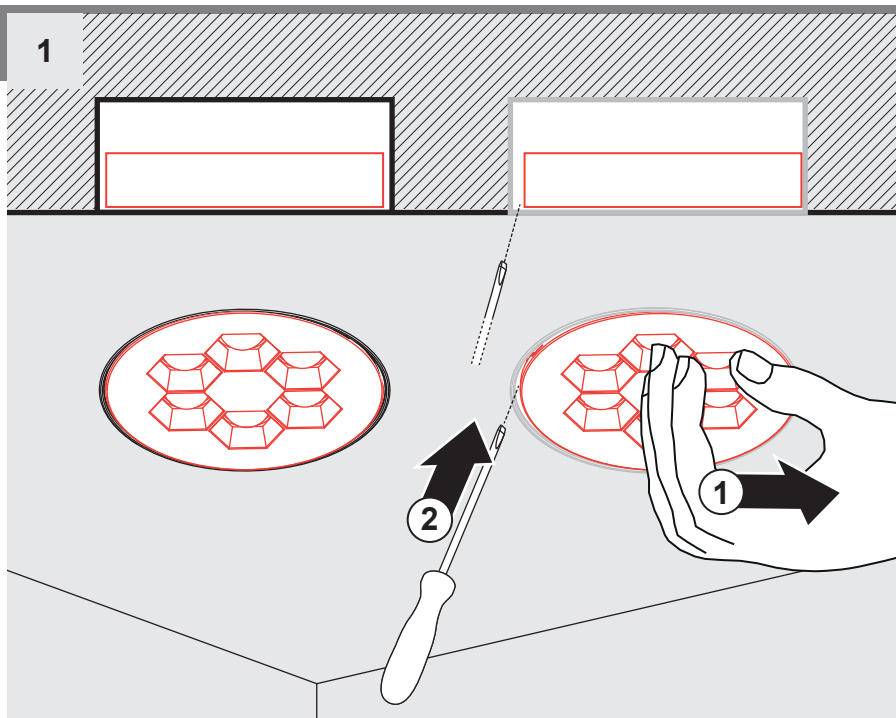

2

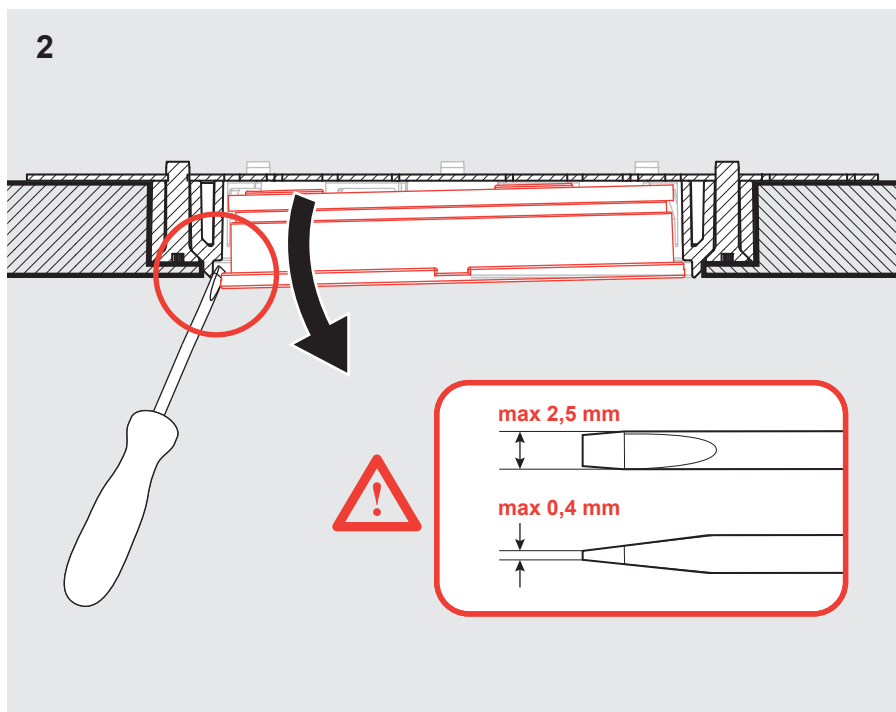



**Artemide®**



## **Artemide**

via Bergamo, 18  
20006 Pregnana M.se (MI)  
ITALIA

tel. +39 02 935 181  
fax +39 02 935 90 254  
fax +39 02 935 90 496

[www.artemide.com](http://www.artemide.com)

VAT IT00846890150

## **Artemide Inc.**

250 Karin Lane  
Hicksville, NY 11801

tel. 631 694 9292  
Toll Free 1-877-Art-9111  
Fax 631 694 9275

[www.artemide.net](http://www.artemide.net)

cod. Y513002019B